

ALL WEATHER HIGH SPEED DOORS

CRASH FORGIVING & AUTOMATICALLY RE-INSERTING



ALL WEATHER
HIGH SPEED DOORS

**Designed for exterior use,
with storm force wind exposure.**

*DYNACO is a unique “patented” concept offering:
The safest, fastest, best sealing doors, with the
lowest maintenance cost in the industry.*



ALL WEATHER M2 Designed for exterior environments.

Resists and operates under pressures up to:

Maximum dimensions: W 18' x H 18'

Width (ft.)	UP TO 7'	8'	9'	10'	11'	12'	13'	14'	15'	16'	17'	18'
Pressure (lbs./sq.ft.)	88.78	77.68	69.05	62.14	56.49	51.79	47.80	44.39	41.43	38.84	36.56	34.52
Wind speed* (mph)	185	170	162.5	150	145	140	135	130	125	122.5	120	115

*Wind speed is indicative, not including any multiplication coefficients taking into account the configuration of the building.

DESCRIPTION

STANDARD OPERATING SPEED: 48"/sec. Optional speeds up to 96"/sec. upon request depending on door size.

OPERATING TYPE: gear driven, push-pull movement.

SIDE GUIDE made of structural channels of 3 1/8" x 1 5/8" x 1/8" in galvanized steel.

INNER SIDE GUIDE in polyethylene (PE-UHMW 1000); outer section 7/8" x 1 9/16", on springs. Galvanized side covers included.

DRUM in steel, diameter 4" x 0.078", shafts in steel.

DOOR CURTAIN in reinforced PVC (27 oz/sq. yd). Available in different colors and provided with side sealing zippers; soft bottom edge design.

MOTOR without brake, with 4 poles, controlled by a variable speed drive. Power: 1 HP for a door surface up to 18 sq.yds; 2 HP (larger surface).

Protection degree NEMA 4.

GEARBOX size 50 for a motor of 1 HP and gear reduction ratio 1/7; size 63 for 2 HP.

DETECTORS: An infrared photocell installed inside the side guide and detecting the presence of a pedestrian or a vehicle. Upon activation, it opens the door immediately and keeps it open as long as the presence is detected. Height of the photocell: 12" from the floor. (Optional: up to maximum 24" from the floor).

A bottom edge detector opens the door when it hits an obstacle during the closing cycle. This detector is positioned at the bottom part of the curtain.

POWER SUPPLY: Standard: single phase 208-230 VAC, three phase 208-230 VAC, three phase 460 VAC. Optional: three phase 575 VAC.

Frequency: 50-60 Hz. Circuit breakers to be provided by the customer: 10A for a motor of 1 HP and 16A for 2 HP.

SPACE REQUIREMENTS: All indicated dimensions are net: the

additional space necessary for mounting and maintenance has to be taken into account. Reduced dimensions upon request.

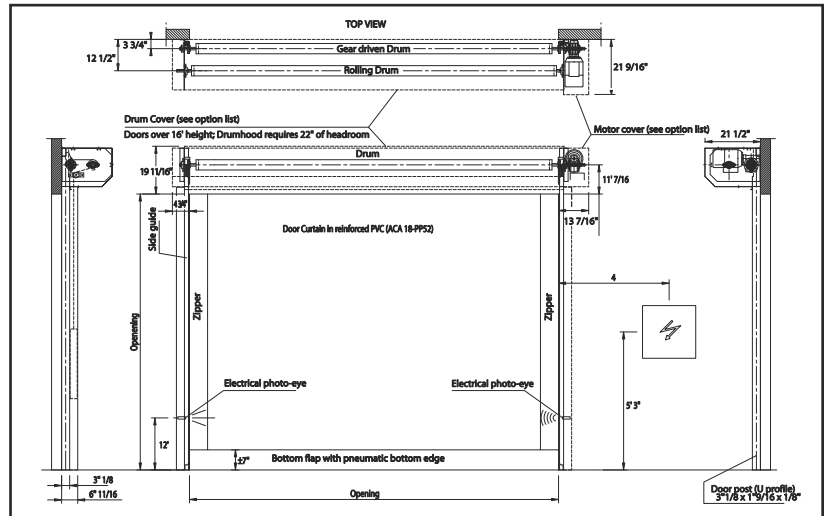

ALL WEATHER M3 Designed for exterior environments.

Resists and operates under pressures up to:

Maximum dimensions: W 39' x H 18'

Width (ft.)	UP TO 19'	20'	21'	23'	25'	27'	29'	31'	33'	35'	37'	39'
Pressure (lbs./sq.ft.)	32.71	31.07	29.59	27.02	24.86	23.03	21.43	20.05	18.83	17.76	16.80	15.93
Wind speed* (mph)	110	107.5	105	100	97.5	95	90	87.5	85	82.5	80	77.5

*Wind speed is indicative, not including any multiplication coefficients taking into account the configuration of the building.

DESCRIPTION

STANDARD OPERATING SPEED: 31.2"/sec.

OPERATING TYPE: gear driven, push-pull movement.

SIDE GUIDE made of structural channels of 3 15/16" x 2" x 1/8" in galvanized steel.

INNER SIDE GUIDE in polyethylene (PE-UHMW 1000); outer section 7/8" x 1 9/16", on springs. Galvanized side guide covers included.

DRUM in steel, diameter 5 1/2" x 1/8", shafts in steel.

DOOR CURTAIN in reinforced PVC (27 oz/sq.yd). Available in different colors and provided with side sealing zippers; soft bottom edge design.

MOTOR without brake, with 4 poles, controlled by a variable speed drive. Power: 2 HP for a door surface up to 44 sq.yds; 3 HP (larger surface).

Protection degree NEMA 4.

GEARBOX size 63 for a motor of 2 HP and gear reduction ratio 1/15; size 90 for 3 HP.

DETECTORS: An infrared photocell installed inside the side guide and detecting the presence of a pedestrian or a vehicle. Upon activation, it opens the door immediately and keeps it open as long as the presence is detected. Height of the photocell: 12" from the floor. (Optional: up to maximum 24" from the floor).

A bottom edge detector opens the door when it hits an obstacle during the closing cycle. This detector is positioned at the bottom part of the curtain.

POWER SUPPLY: Standard: single phase 208-230VAC, three phase 208-230 VAC, three phase 460 VAC. Optional: three phase 575 VAC.

Frequency: 50-60 Hz. Circuit breakers to be provided by the customer: 16A for a motor of 2 HP and 25A for 3 HP.

SPACE REQUIREMENTS: All indicated dimensions are net: the

additional space necessary for mounting and maintenance has to be taken into account. Reduced dimensions upon request.

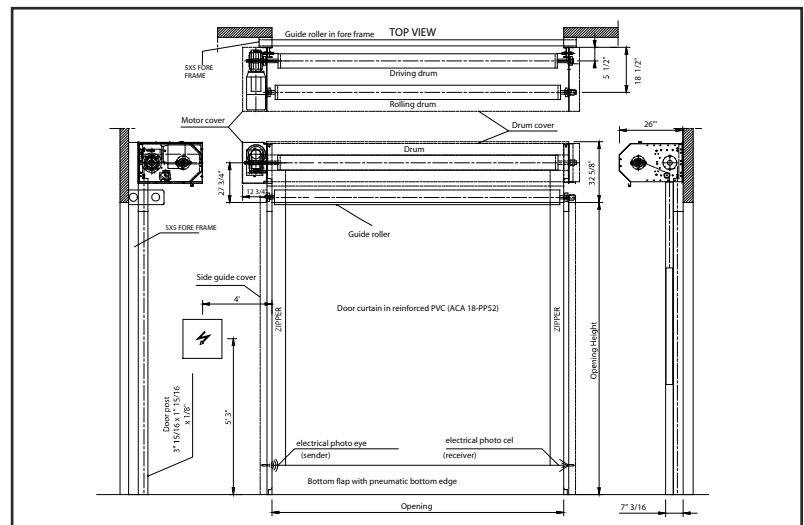

Within the framework of its policy of continuous development of its products, DYNACO reserves the right to modify the characteristics of its products and parts without prior notice.



The Leader in Door Safety and Design